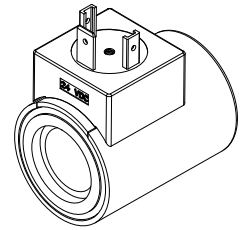

Solenoid coil V.E37/19
 according to VDE 0580
 Protection class IP 65/67/69K

DESCRIPTION

The slip-on solenoid coil V.E37/19 is available in two sizes and with three different connection versions (see type code). The construction corresponds to the VDE 0580 standard. The housing is made of steel (nickel-chromium coated), the connector socket is made of plastic material.

FUNCTION

With the combination of an armature tube the function of a switching solenoid or of a proportional solenoid results. The solenoid coils are available with the standard nominal voltages as AC and DC versions.

APPLICATION

The solenoid coils are mainly utilised in hydraulic applications.

TYPE CODE

Metal housing round with one-sided collar					V	<input type="checkbox"/>	E37 / 19	x	<input type="checkbox"/>	-	<input type="checkbox"/>	#	<input type="checkbox"/>
Connection execution													
Connector socket EN 175301-803/ISO 4400													
Connector socket AMP Junior-Timer													
Connector Deutsch DT04-2P													
Coil execution													
Internal coil diameter 19 mm													
Coil clamping length	40 mm	<input type="checkbox"/>	50 mm	<input type="checkbox"/>									
Nominal voltage U _N	12 VDC	<input type="checkbox"/>	24 VDC	<input type="checkbox"/>	115 VAC	<input type="checkbox"/>	230 VAC	<input type="checkbox"/>					
Design-Index (Subject to change)													

SPECIFICATIONS

Coil winding insulation class H (180 °C)
 Relative duty factor 100% DF/ED
 combined with armature tube and valve
 Ambient temperature -20...+50 °C
 Corrosion protection Salt spray test according to EN ISO 9227: ≥ 200 h

SAFE OPERATION

Caution: Because of the danger of over-heating the solenoid coil must only be commissioned together with an armature tube as well as with a valve.

		12 VDC	24 VDC	115 VAC	230 VAC
V.E37/19x40	Nominal power (W) (Switching function)	18	18	18	18
	Limiting power (W) (Proportional function)	12,5	12,5	–	–
	Limiting current (50 °C) (A) (Proportional function)	1,00	0,52	–	–
	Nominal resistance (Ω)	8	32	675	2550
	Number of windings (–)	750	1500	6400	12800
	Weight of solenoid coil (kg)	0,17	0,17	0,17	0,17

		12 VDC	24 VDC	115 VAC	230 VAC
V.E37/19x50	Nominal power (W) (Switching function)	22	22	22	22
	Limiting power (W) (Proportional function)	16	15	–	–
	Limiting current (50 °C) (A) (Proportional function)	1,20	0,63	–	–
	Nominal resistance (Ω)	6,4	27,2	520	1950
	Number of windings (–)	780	1560	6650	13300
	Weight of solenoid coil (kg)	0,2	0,2	0,2	0,2

TYPE LIST / DIMENSIONS / GENERAL SPECIFICATIONS

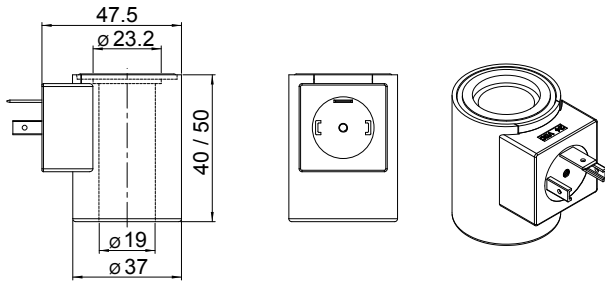

Execution: V **D** E37/19x...

- 3-poles 2 P+E
 - Protection class IP 65
- With corresponding mating connector (not included in delivery) and professional assembly.

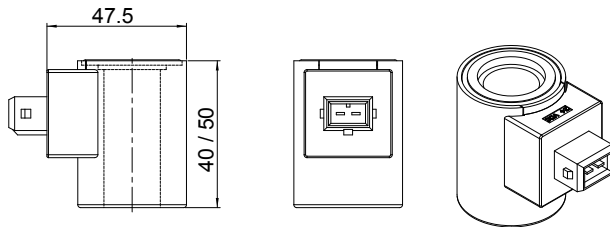

Execution: V **J** E37/19x...

- 2-poles 2P
 - only for $U_N \leq 75$ VDC
 - Protection class IP 66
- With corresponding mating connector (not included in delivery) and professional assembly.

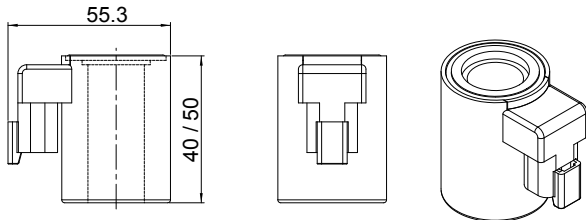

Execution: V **G** E37/19x...

- 2-poles 2P
 - only for $U_N \leq 75$ VDC
 - Protection class IP 67 and 69 K
- With corresponding mating connector (not included in delivery) and professional assembly.

Technical explanation see data sheet 1.1-400 and 1.1-410