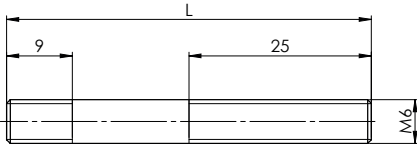
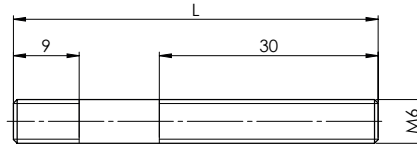

**Befestigungen  
 zu Höhenverkettung**
**NG10**
**STIFTSCHRAUBE M6xL**

**STIFTSCHRAUBE M6xL K8**

Klemmlänge	Abmessung	Artikel Nummer	Klemmlänge	Abmessung	Artikel Nummer
73 ... 89	M6x106	224.3000	68 ... 89	M6x106	224.3063
82 ... 96	M6x115	224.3002	77 ... 96	M6x115	224.3050
96 ... 112	M6x129	224.3003	91 ... 112	M6x129	224.3051
108 ... 124	M6x141	224.3004	103 ... 124	M6x141	224.3052
120 ... 136	M6x153	224.3006	115 ... 136	M6x153	224.3053
128 ... 144	M6x161	224.3007			
140 ... 156	M6x173	224.3008	135 ... 156	M6x173	224.3054
149 ... 165	M6x182	224.3009	144 ... 165	M6x182	224.3055
159 ... 175	M6x192	224.3010	154 ... 175	M6x192	224.3056
175 ... 191	M6x205	224.3011	170 ... 191	M6x205	224.3057
187 ... 203	M6x220	224.3012	182 ... 203	M6x220	224.3058
196 ... 212	M6x229	224.3013	191 ... 212	M6x229	224.3060
204 ... 220	M6x237	224.3014	199 ... 220	M6x237	224.3059
213 ... 229	M6x246	224.3019			
225 ... 241	M6x258	224.3015	220 ... 241	M6x258	224.3062
234 ... 250	M6x267	224.3016			
252 ... 268	M6x285	224.3020	247 ... 268	M6x285	224.3061
			259 ... 280	M6x297	224.3066
292 ... 308	M6x325	224.3018			
360 ... 378	M6x393	224.3021	355 ... 378	M6x393	224.3065

 Material: ETG100  
 Oberfläche: brüniert

Material: Rostfrei 1.4057

**HALSMUTTER M6**

Art. Nr. 154.7400

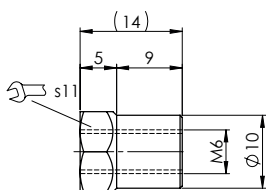

Anzugdrehmoment: 9.5 Nm

Für A.4x10 (1.2-71)

**HALSMUTTER M6**

Art. Nr. 154.0602

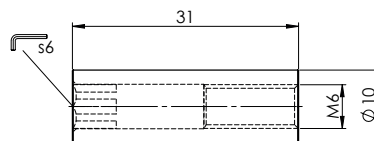

Anzugdrehmoment: 9.5 Nm

Für WDMFA10 (1.2-76)