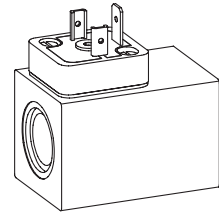

**Solenoid coil M.S35/16x53  
 to VDE 0580  
 Protection class IP65/IP67**

**DESCRIPTION**

The slip-on solenoid coil M.35/16x53 is available with different types of electric connections (see type code). The construction corresponds to standard VDE 0580. The steel housing is zinc coated.

**FUNCTION**

In combination with the corresponding armature tube the function of an on-off solenoid or proportional solenoid will be obtained. The AC voltage type incorporates a rectifier. The available AC voltages are listed in the type code section.

**APPLICATION**

Due to its robust design the coil is mainly intended for hydraulic applications.

**TYPE CODE**

Metal housing, square	M	<input type="checkbox"/>	S35/16x53	-	<input type="checkbox"/>	-	<input type="checkbox"/>	#	<input type="checkbox"/>
Electric connection:									
Connector socket ISO 4400 / DIN 43650			<input type="checkbox"/>	D					
Connector socket AMP Junior-Timer			<input type="checkbox"/>	J					
Flying leads execution			<input type="checkbox"/>	L					
Cable execution			<input type="checkbox"/>	K					
Bayonet connector			<input type="checkbox"/>	B					
Coil types									
Internal coil diameter 16 mm									
Coil length 53 mm									
Standard-nominal voltage U <sub>N</sub> :									
12 VDC				<input type="checkbox"/>	G12				
24 VDC				<input type="checkbox"/>	G24				
110 VAC				<input type="checkbox"/>	R110	*			
115 VAC				<input type="checkbox"/>	R115	*			
230 VAC				<input type="checkbox"/>	R230	*			
* AC-Execution:									
- Only with connection type: «D», «K», «B», «K...-M28»									
- 50 to 60 Hz									
- Rectifier integrated in the plug plate									
- Other nominal voltages and nominal power on request									
Appendix:									
Special cable execution				<input type="checkbox"/>	M28				
Design-Index (Subject to change)									

**SPECIFICATIONS**

			12 VDC	24 VDC	115 VAC	230 VAC
Coil winding	min. H (180 °C)					
insulation class						
Protection class	depending on the connector version IP65 or IP67 according to EN 60 529 (if correctly mounted)					
Relative duty factor	100 % DF when mounted on armature tube and valve					
Ambient temperature	-20...+90 °C					
Nominal voltage range	10–250 VDC 24–250 VAC					
		Nominal power (W) (Switching function)	22	22	22	22
		Limiting power (W) (Proportional function)	11,3	11,7	–	–
		Limiting current (50 °C) (A) (Proportional function)	1,25	0,68	–	–
		Nominal resistance (Ω)	7,2	25	420	1500
		Number of windings (–)	800	1550	5930	11400
		Weight of solenoid coil (kg)	0,37	0,37	0,37	0,37

**SAFE OPERATION**

**Caution:** To avoid overheating the coil may only be energised when mounted on an armature tube and valve.

TYPE LISTE / DIMENSIONS / GENERAL SPECIFICATIONS

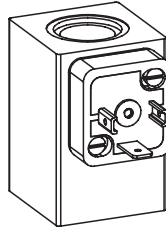
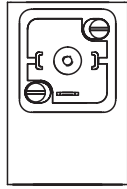
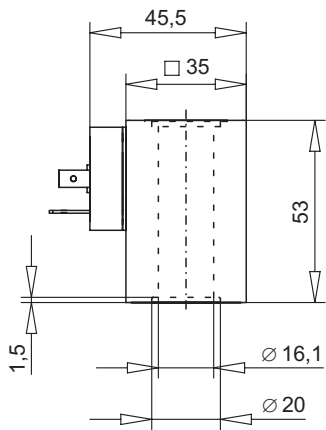

Execution: M **D** S35/16x53-...

- 3 contacts 2 P+E
  - DC- and AC-execution available
  - Connector socket plastic
  - Protection class IP65
- With corresponding mating connector and professional assembly.

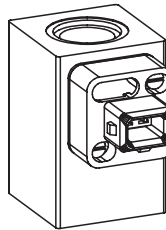
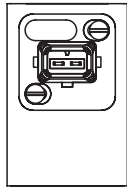
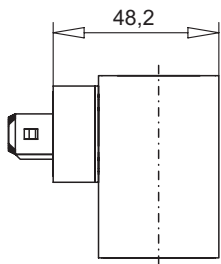

Execution: M **J** S35/16x53-...

- 2 contacts 2P
  - DC-execution available
  - only for  $U_N \leq 75VDC$
  - Connector socket plastic
  - Protection class IP65
- With corresponding mating connector and professional assembly.

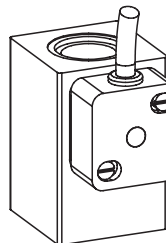
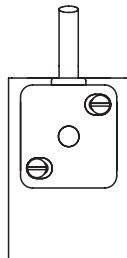
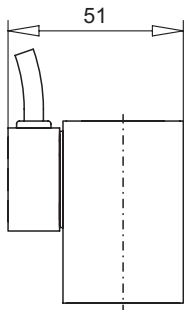

Execution: M **K** S35/16x50-...

- 3 conductors 2P+E 3 x 0,75 mm<sup>2</sup>
  - Thermoplast
  - Cable length 1500 mm
  - Cable diameter 6 mm
  - DC- and AC-execution available
  - Cable housing plastic
  - Protection class IP67
- With professional assembly.

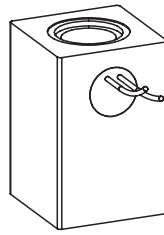
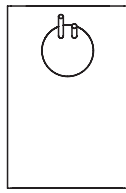
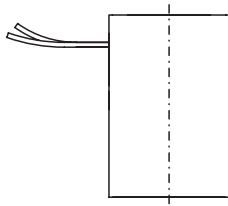

Execution: M **L** S35/16x53-...

- 2 leads 2P (2x 0,25 mm<sup>2</sup>) Radox 155
  - Cable length 500 mm
  - DC-execution available
  - only for UN ≤ 75VDC
  - Protection class IP65
- With professional assembly.

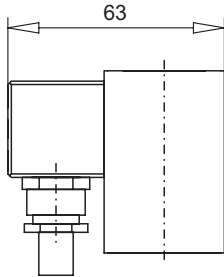

**DC-execution**

Execution: M **K** S35/16x53-...**M28**

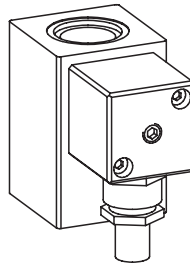
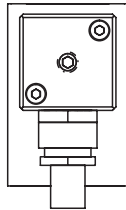

- 3 conductors 2P+E 2x 1 mm<sup>2</sup> [+E] (acc. to IEC 332)
  - Cable length 1500 mm
  - DC- and AC-execution available
  - Cable housing steel
  - Protection class IP67
- With professional assembly.

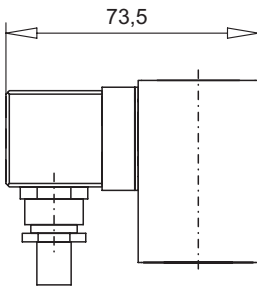

**AC-execution**

- Plastic rectifier housing

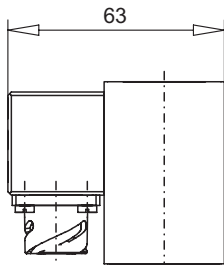
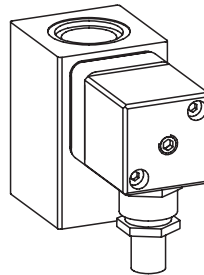
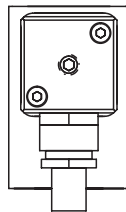

**DC-execution**

Execution: M **B** S35/16x53-...

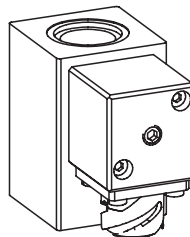
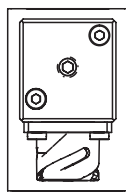

- 3 contacts 2P+E
  - DC- and AC-execution available
  - Connector housing steel
  - Protection class IP67
- With corresponding mating connector and professional assembly.

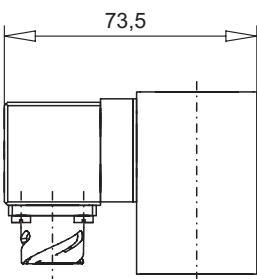

**AC-execution**

- Plastic rectifier housing

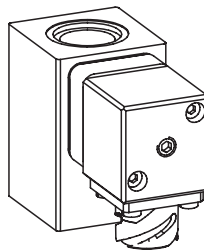
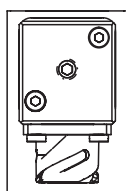

Neutral conductor Phase



Earthing conductor

Technical explanation see data sheet 1.1-400